

NOTES:
IRRIGATION WATER RIGHTS WILL BE TRANSFERRED TO THE CITY OF TWIN FALLS REGIONAL IRRIGATION DISTRICT AND A LOW PRESSURE IRRIGATION SYSTEM WILL BE PROVIDED.

ALL INTERIOR LOT LINES HAVE A 5' UTILITY EASEMENT.

REF:
WARRANTY DEEDS #226-3203 & # 1994-007370. EASTWOOD SUBDIVISION PHASE 1, #2002-011521. EASTWOOD SUBDIVISION PHASE 2, #2002-025653.

EASTWOOD SUBDIVISION, PHASE 3

A PORTION OF
THE NE 1/4 SE 1/4, SECTION 14
T. 10 S., R. 17 E., B.M.
TWIN FALLS COUNTY, IDAHO
2003
9.13 ACRES

Twin Falls County, Idaho
Recorded for:
MESSERSMITH
08:27am Oct. 02, 2003
2003-025707
No. of Pages: 2 Fee: \$22.00
KRISTINA GLASCOCK
County Clerk
Deputy: CD

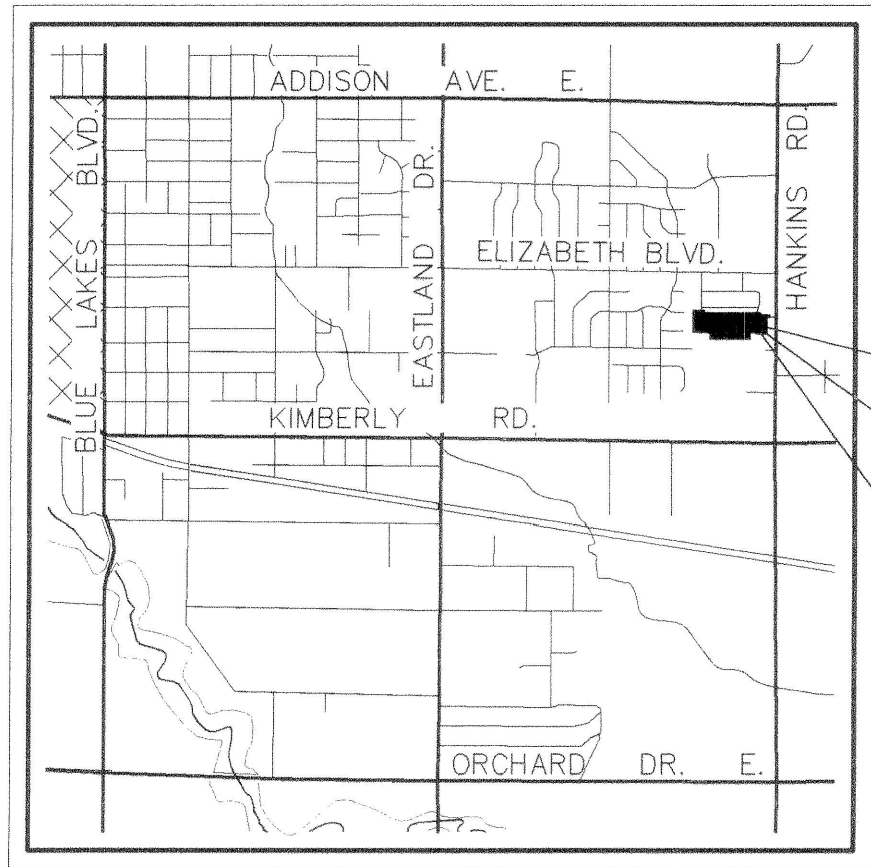
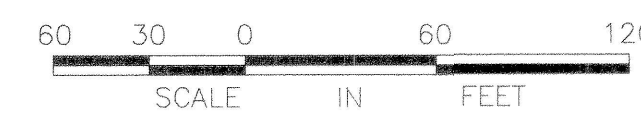

VICINITY MAP
NOT TO SCALE

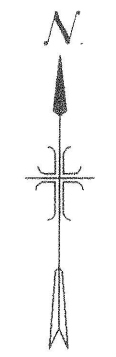

EASTWOOD SUBDIVISION PHASE 3

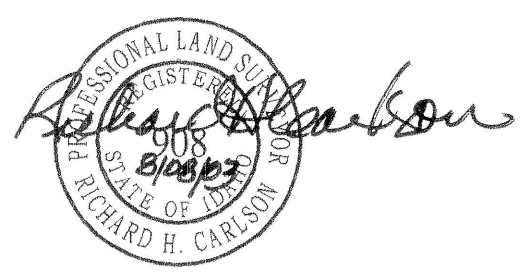

HEALTH CERTIFICATE

SANITARY RESTRICTIONS AS REQUIRED BY IDAHO CODE TITLE 50, CHAPTER 13, HAVE BEEN SATISFIED. SANITARY RESTRICTIONS MAY BE REIMPOSED, IN ACCORDANCE WITH THE IDAHO CODE TITLE 50, CHAPTER 13, SECTION 50-1326, BY THE ISSUANCE OF A CERTIFICATE OF DISAPPROVAL.

9-17-03
DATE

Richard H. Carlson
DEPARTMENT OF ENVIRONMENTAL QUALITY, EHS

CURVE DATA TABLE

CURVE	DELTA	RADIUS	ARC	CHORD	TANGENT	CHORD BEARING
C-1	89°57'16"	20.00'	31.40'	28.27'	19.98'	S 44°58'38" W
C-2	90°00'00"	20.00'	31.42'	28.28'	20.00'	N 45°02'44" W
C-3	90°00'00"	20.00'	31.42'	28.28'	20.00'	N 44°57'16" E
C-4	90°00'00"	20.00'	31.42'	28.28'	20.00'	S 45°02'44" E
C-5	49°59'41"	20.00'	17.45'	16.90'	9.33'	S 24°57'07" W
C-6	31°56'08"	50.00'	27.87'	27.51'	14.31'	S 33°58'53" W
C-7	43°13'25"	50.00'	37.72'	36.83'	19.81'	S 03°35'53" E
C-8	43°13'25"	50.00'	37.72'	36.83'	19.81'	S 46°49'19" E
C-9	43°13'25"	50.00'	37.72'	36.83'	19.81'	N 89°57'16" E
C-10	43°13'25"	50.00'	37.72'	36.83'	19.81'	N 46°43'51" E
C-11	43°13'25"	50.00'	37.72'	36.83'	19.81'	N 03°30'25" E
C-12	31°56'08"	50.00'	27.87'	27.51'	14.31'	N 34°04'21" W
C-13	49°59'41"	20.00'	17.45'	16.90'	9.33'	N 25°02'35" W
C-14	90°00'00"	20.00'	31.42'	28.28'	20.00'	N 44°57'16" E
C-15	90°00'00"	20.00'	31.42'	28.28'	20.00'	S 45°02'44" E
C-16	49°59'41"	20.00'	17.45'	16.90'	9.33'	S 24°57'07" W
C-17	31°56'08"	50.00'	27.87'	27.51'	14.31'	S 33°58'53" W
C-18	43°13'25"	50.00'	37.72'	36.83'	19.81'	S 03°35'53" E
C-19	43°13'25"	50.00'	37.72'	36.83'	19.81'	S 46°49'19" E
C-20	43°13'25"	50.00'	37.72'	36.83'	19.81'	N 89°57'16" E
C-21	43°13'25"	50.00'	37.72'	36.83'	19.81'	N 46°43'51" E
C-22	43°13'25"	50.00'	37.72'	36.83'	19.81'	N 03°30'25" E
C-23	31°56'08"	50.00'	27.87'	27.51'	14.31'	N 34°04'21" W
C-24	49°59'41"	20.00'	17.45'	16.90'	9.33'	N 25°02'35" W
C-25	90°00'00"	20.00'	31.42'	28.28'	20.00'	N 44°57'16" E
C-26	90°02'44"	20.00'	31.43'	28.30'	20.02'	S 45°01'22" E

LEGEND

- BOUNDARY LINE
- SUBDIVISION LOT BOUNDARY
- SECTION LINE
- CENTERLINE
- UTILITY/DRAINAGE EASEMENT
- BRASS CAP FOUND
- FOUND 5/8"x 30" REBAR
- FOUND 1/2" REBAR
- SET 1/2"x 24" REBAR & CAP
- SET 5/8"x 30" REBAR & CAP
- LOT NUMBER
- B.O.B. BASIS OF BEARING

RIEDEL & ASSOCIATES, INC.
202 FALLS AVENUE
TWIN FALLS, IDAHO 83301
EASTWOOD SUBDIVISION, PHASE 3
SHEET 1 OF 2

