

Plat Showing ROCK LEDGE ESTATES SUBDIVISION NO. 1

Situated in a Portion of the East 1/2 of the Southeast 1/4 of Section 15,
Township 10 South, Range 18 East, B.M., Twin Falls County, Idaho
2008

TWIN FALLS COUNTY
RECORDED FOR:
THE LAND GROUP
12:23:38 pm 03-24-2009
2009-006326
NO. PAGES: 4 FEE: \$44.00
KRISTINA GLASCOCK
COUNTY CLERK
DEPUTY: CHICE

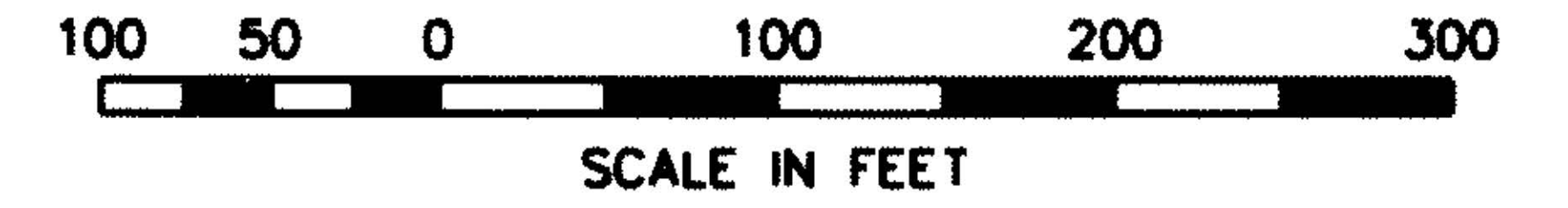

Sheet Index
SHEET 1 - BOUNDARY PLAT MAP
SHEET 2 - DETAILS, LEGEND & CURVE TABLE
SHEET 3 - CERTIFICATE OF OWNER & PLAT NOTES
SHEET 4 - CERTIFICATES AND APPROVALS

VICINITY MAP
N.T.S.

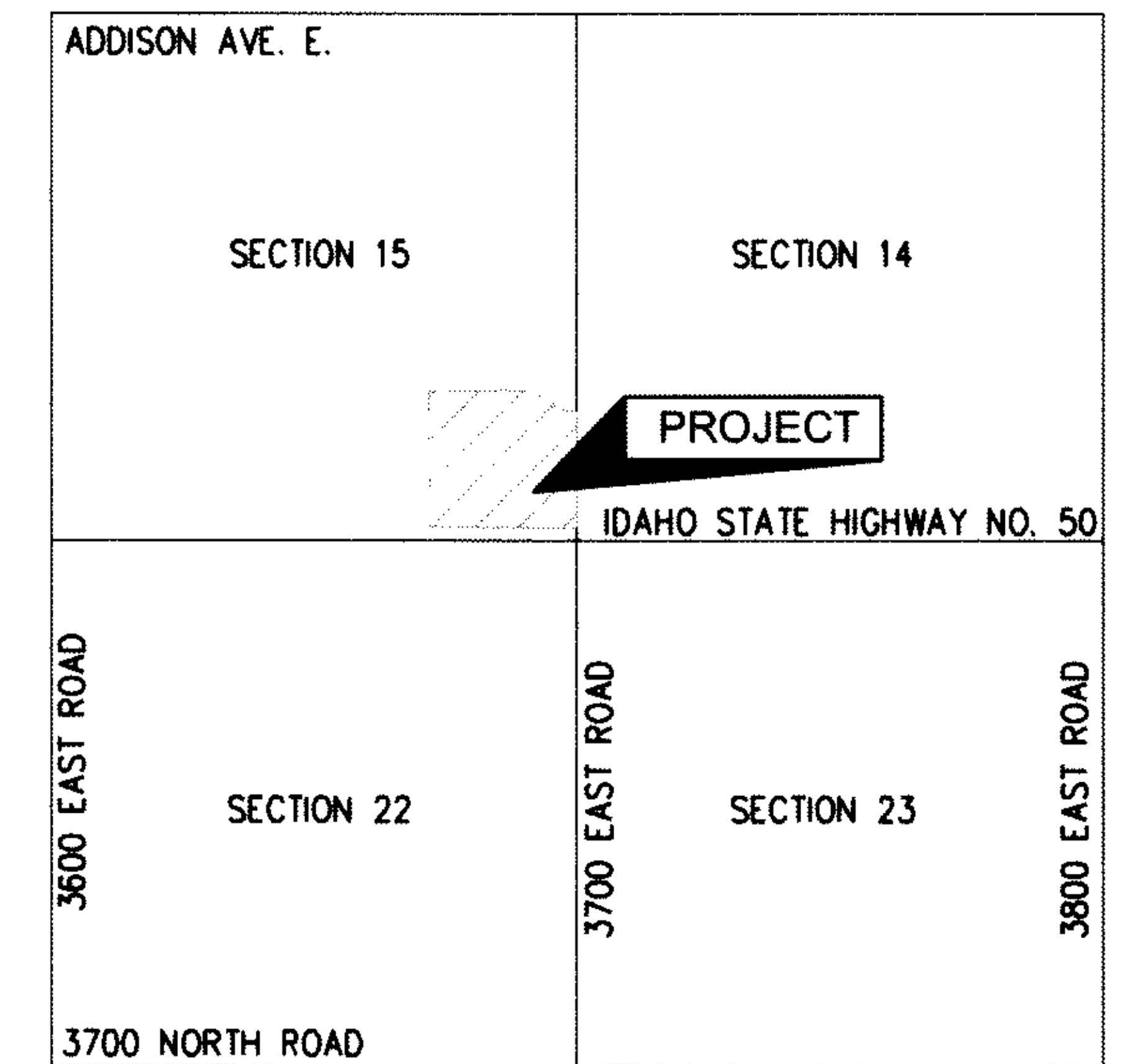

HEALTH CERTIFICATE

SANITARY RESTRICTIONS AS REQUIRED BY IDAHO CODE TITLE 50, CHAPTER 13, HAVE BEEN SATISFIED. SANITARY RESTRICTIONS MAY BE REIMPOSED, IN ACCORDANCE WITH IDAHO CODE TITLE 50, CHAPTER 13, SECTION 50-1326, BY THE ISSUANCE OF A CERTIFICATE OF DISAPPROVAL.

[Signature]
SOUTH CENTRAL DISTRICT HEALTH DEPARTMENT, EHS
DATE: *3/15, 2008*

THE LOTS ON THIS PLAT ARE SUBJECT TO RESTRICTION CONCERNING THE LOCATIONS OF WELLS AND SEPTIC SYSTEMS. THESE RESTRICTIONS ARE ON FILE AT THE SOUTH CENTRAL DISTRICT HEALTH DEPARTMENT AND NO SEPTIC PERMITS WILL BE ISSUED WITHOUT THE CONSENT OF THE HEALTH DEPARTMENT AND STRICT CONFORMANCE TO THESE RESTRICTIONS.

TWIN FALLS COUNTY
RECORDED FOR:
THE LAND GROUP
12:23:38 pm 03-24-2009
2009-006326
NO. PAGES: 4 FEE: \$44.00
KRISTINA GLASCOCK
COUNTY CLERK
DEPUTY: CHICE



THE LAND GROUP
INCORPORATED

- Landscape Architecture
- Civil Engineering
- Site Planning
- Golf Course Irrigation & Engineering
- Graphic Communication
- Land Surveying

Owner

TRAUM, LLC
1442 HEYBURN AVE. E.
TWIN FALLS, IDAHO 83301
PHONE: (208)734-3068

261 Canyon Crest Drive
Twin Falls, Idaho 83301
Phone (208) 733-4041
Fax (208) 733-4045
www.thelandgroupinc.com

